

## AOTOLIGHT LIGHT SENSOR SYSTEM manual and installation guide (NQ-L6000)

### Attention

1. This unit is for vehicles with 12V Dc only.
2. It is recommended to have this unit installed by a professional auto technician.
3. Use the same cable for extension.
4. Perform test after finishing the installation.
5. The sensitivity of the light sensor can be adjusted.

### About Autolight

Autolight has been designed to control the vehicle lighting system and will switch the lights on automatically as it gets dark and off when it gets light, it will automatically control your lights without the need for manual operation.

This system is very safe and easy to install and will not affect the vehicle lighting or electrical system.

### How will you benefit from Autolight?

- Saves you having to turn lights ON/OFF when it gets dark or light
- Increases visibility and safety
- Stable in all light conditions
- Practical convenient and easy to use
- Autolight helps you in the following situations

### Key features:

1. Turn your lights ON/OFF automatically when it gets dark/light.
2. Sensitivity of the light sensor can be adjusted.
3. Automatic switching of Lower-beam upper-beam(main beam headlamp).
4. Push button switch on the back of the light sensor will turn the Autolight ON/OFF.
5. Designed for vehicles with negative or positive headlights.
6. No interference with the vehicle's electrical systems.
7. Great convenience and easy installation.
8. Universal for all 12V vehicles.

### Automatic switching of Lower-beam upper-beam

When the upper-beam(main beam headlamp) switch is turned ON, the lower beam will automatically turn OFF.

### Autolight fitting instruction

Wire connection: the following wiring diagrams are examples only, check carefully before the final connection, insulate the wires that are not used.

Light sensor: stick the light sensor on the front windscreen, make sure it is kept away from dark or shaded areas.

ECU: install the ECU at an easily accessible place under the dashboard, should you need to adjust the sensitivity, the factory setting is recommended.

### Technical parameters:

Rated Voltage: 12V  $\pm$ 3V. Max. Rated Current:  $\geq$  30A.

### Step by step installation guide

#### 1. Remove trim

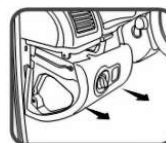

Remove trim from around the light switch

#### 2. Connect wires

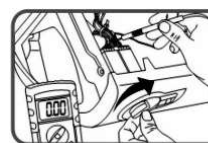

Connect all wires as per wiring diagram

#### 3. Install ECU

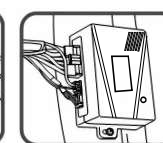

Fasten the ECU

#### 4. Install the light sensor



Light sensor stick to the front window, dust-proof design

#### 5. Connect main beam headlamp wire

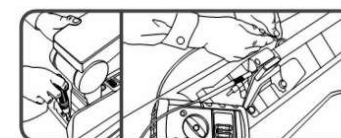

Connect the Black/White wire to main beam headlamp input wire

#### 6. Function test

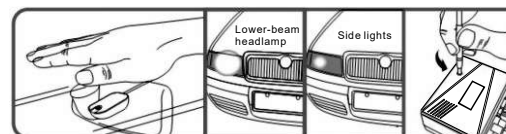

Perform the test when installation is complete

#### 7. Refit trim

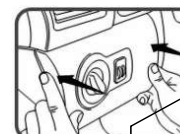

The sensitivity of the light sensor can be adjusted

After completion refit trim

## Autolight helps you in the following situations

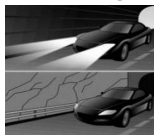

Turn lights on/off automatically when driving in or out of tunnel

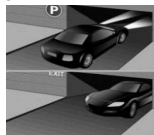

Turn lights on/off automatically when driving in or out of garage



Turn lights on automatically at night



Turn lights on automatically in dark

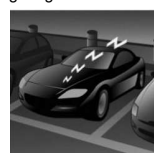

Turn lights off automatically when ignition is off



Perfect performance in all conditions

## Wiring diagram

The wiring diagram may vary due to different types of vehicles

### 1. Negative wiring

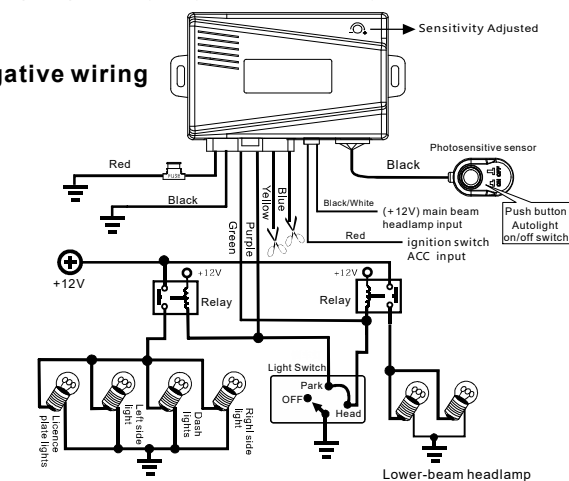

Insulate the yellow and purple wires if they are not connected

3

### 4. Positive trigger wiring

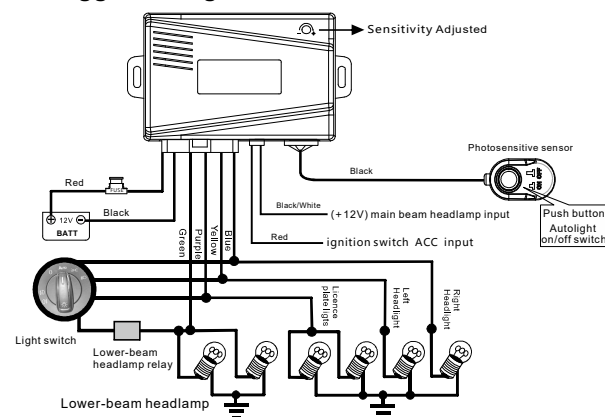

### 3. Positive trigger wiring

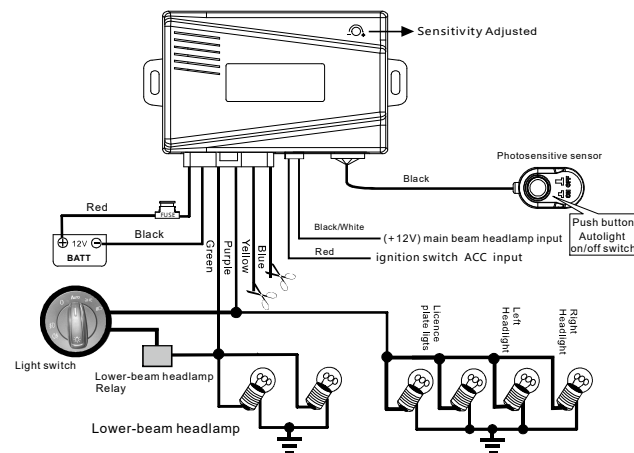

Insulate the yellow and purple wires if they are not connected

**!** If the lights are manually switched on while using the autolight .make sure the light are switch off before the ignition is turned off

4