

## 261 T Transponder immobilizer

### Electrical connection

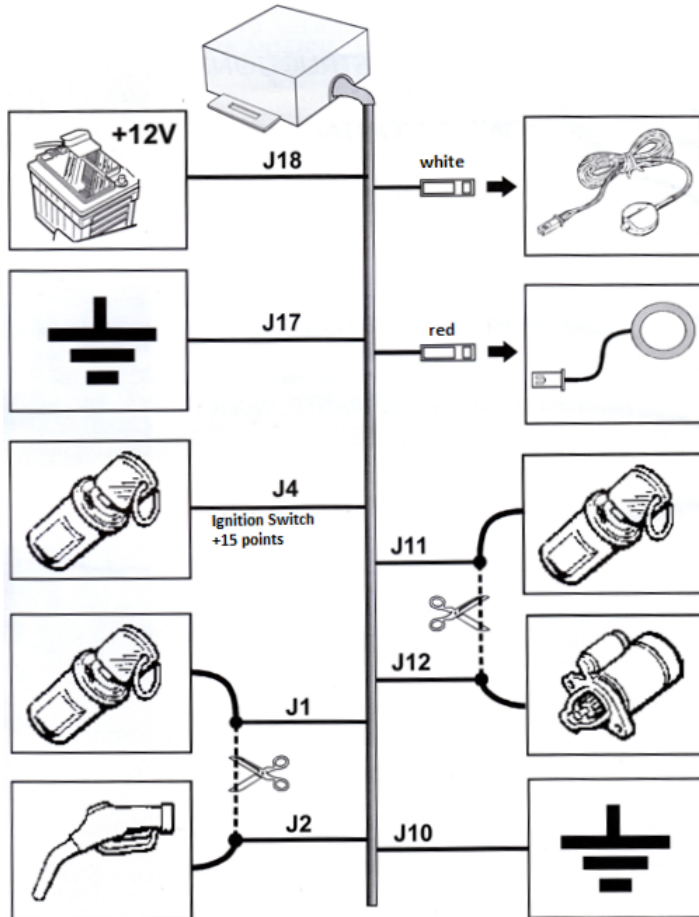

### Sensor placement

Number		LED flashing		
5		LED 5 x flashes		Pause for 2 seconds
6		LED 6 x flashes		Pause for 2 seconds
0		LED 10 x flashes		Pause for 2 seconds
5		LED 5 x flashes		Pause for 2 seconds
4		LED 4 x flashes		Pause for 2 seconds

### Installing an immobilizer

Attach the immobilizer to a hard-to-reach place behind or under the instrument panel, glove box, seat where it will not be exposed to water or heat. Route the wires so that no voltage is generated (away from the ignition cable and spark plugs).

### LED indicator placement

Place the LED in a conspicuous place inside and out. Clean the surface for better adhesion.

### Engine Block

#### Ignition or fuel lock

Locate the connection to the ignition switch and fuel pump. Cut the. Connect wire J1 to the ignition switch. Connect wire J2 e.g. to the fuel pump. Solder and insulate the wires.

Note: Do not block a positive circuit (J2 secondary ignition to J4).  
Do not swap connections J1 and J2, as this will cause damage!

### Start block

Locate the connection to the take-up coil and relay. Cut the wire. Connect wire J11 to ignition switch. Connect wire J12 to the starter motor. Solder and insulate the wires.

Connect J10 (optional) to ground, separate from J17.

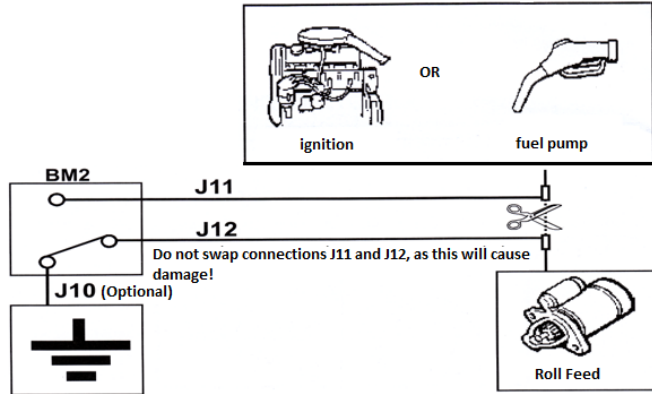

#### Functional description

The immobilizer provides reliable protection. It blocks the two most important elements of the vehicle electronics that are needed for starting (intake coil, fuel pump, injection, ignition), preventing unauthorized starting of the vehicle. Automatic activation 60 seconds after stopping.

The immobilizer is turned off by the transponder when it is touched to the reader, which is usually located on the dashboard. After switching off, it has 60 seconds to start the car, otherwise it will re-arm.

Note: If the transponder is close to the sensor, the immobilizer will arm automatically, but the LED will remain off.

All wires of the immobilizer are black numbered at the end of the wire.

After installation, the end of the cable must be cut off. All connections must be wrapped around with solder or heat-shrink

tape. It is very important that the numeric code is cut off from all wires at the end of the installation operation.

#### Training

If one or more transponders are lost, it is necessary to train the new transponder.

Turn off the system with the original transponder.

Ignite the vehicle.

Place the transponder on the sensor for 10 seconds.

The sensor reads the transponder, then turn off the ignition.

Remove the transponder from the sensor.

Check that the LED is lit continuously to indicate the start of the procedure.

The LED stays on for 10 seconds, touch the new transponder to the sensor, then touch the old one. Recognition and learning of each transponder is indicated by a short time the LED goes out. After 10 seconds after learning the last transponder, the immobilizer automatically exits the menu and enters the pin code using the LED display.

Once you have recorded the new pin code, check that the new transponders are working. If they do not work, repeat the process again.

Up to 25 transponders can be taught.

After training, old lost transponders will be unusable.

#### Pin code

The pin code can also be found on the red transponder card, below the scratch-off surface. Or you can know the pin code with the help of the LED during the teaching process. After entering the training process, the LED goes out after 10 seconds, then in 5 series the LED flashes to enter the 5-digit pin code. The table below shows an example.

In the example shown, the pin code to be recorded is 56054. After each training, write down the pin code because the code may change with each teaching. Keep the pin code with you, but do not leave it in the car.

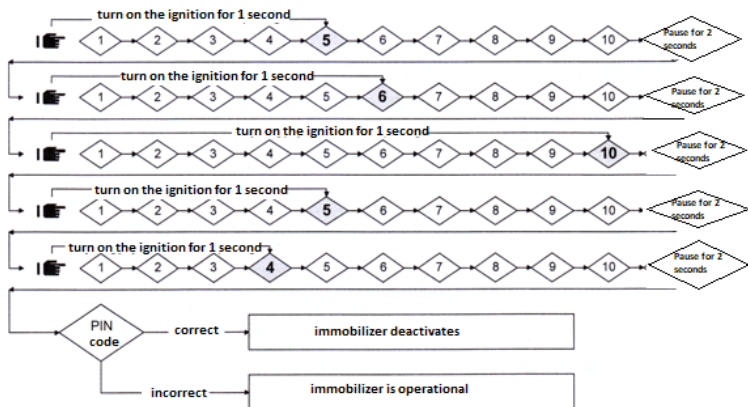

### Disable immobilizer using pin code

If the transponder does not work or the transponders are lost,

allow these steps to disable the immobilizer:

With a sharp immobilizer, turn on the ignition.

The red LED stays on for 10 seconds.

When the LED goes out, turn off the ignition within 2 seconds. If

the ignition is not switched off, the LED will start flashing.

The LED starts flashing which means that the pin code can be

entered into the immobilizer. If the LED flash is not interrupted,

the LED will flash 11 times. When the LED reaches the correct

number, turn on the ignition for 1 second.

The table below shows an example.

The code to be entered is 56054. Wait until the LED flashes 5 and

turn on for 1 second. After a pause of 2 seconds, the LED will

start flashing again, then turn on the ignition again after the 6th

flash. 0 LED 10 will flash. Continue the process until you have recorded all the digits of the pin code.

If the entered pin code is correct, the immobilizer switches off and automatically enters the teach-in function, as evidenced by the continuous LED illumination for 10 seconds.

If the entered pin code is incorrect, the LED will not light and the immobilizer will remain sharp.

Technical specification

Power supply; 12 V DC

Power consumption; 1.5M

Re-sharpening; 60 seconds

Relay sensor capacity; 20 A

Sensor range; 3 cm

Number of transponders that can be taught; max. 25

### Problem solving

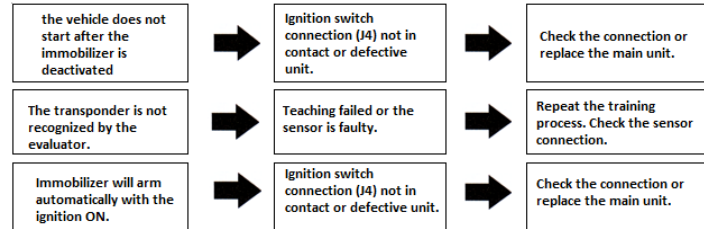

**Note: The manufacturer and importer are not liable for damage caused by incorrect installation of the immobilizer.**

Manufacturer: Laser Line

Via Don Locatelli, 51 20877 RONCELLO - (MB) Italy

Importer; S.M.Power Kft

2310 Szigetszentmiklós, Csepeli út 15

[www.smpower.eu](http://www.smpower.eu)